

SARAH INYOUNG PARK

Elegant Street Footwear



1. Traditional VS New System



Choose Last & Outsole

Design New Last

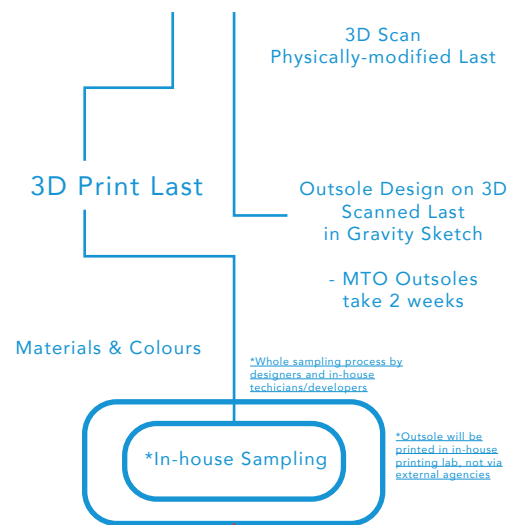
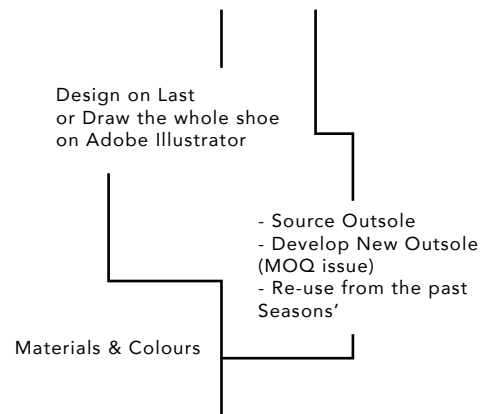

2. 3D Last : Design & Development

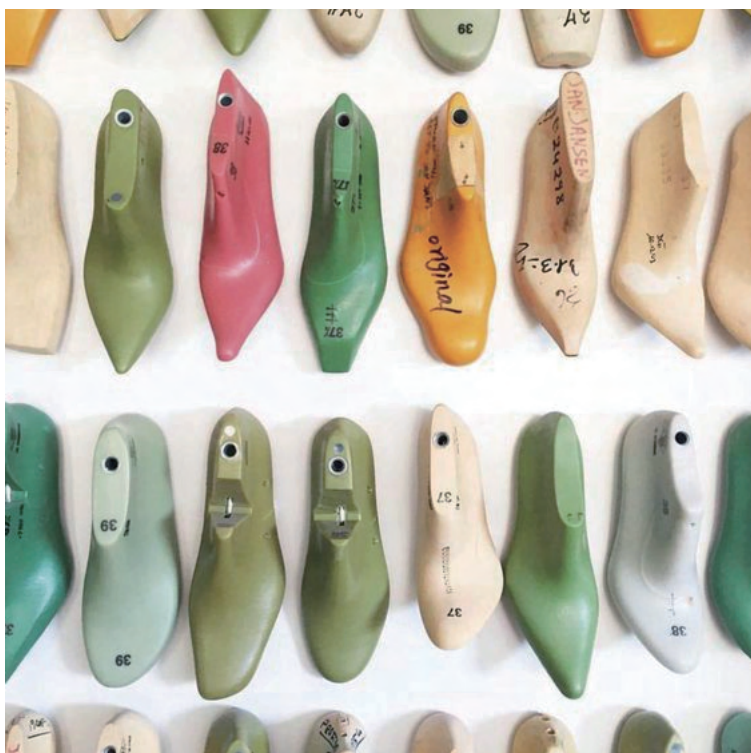

2. 3D Last : Design & Development



Cork-modified Last

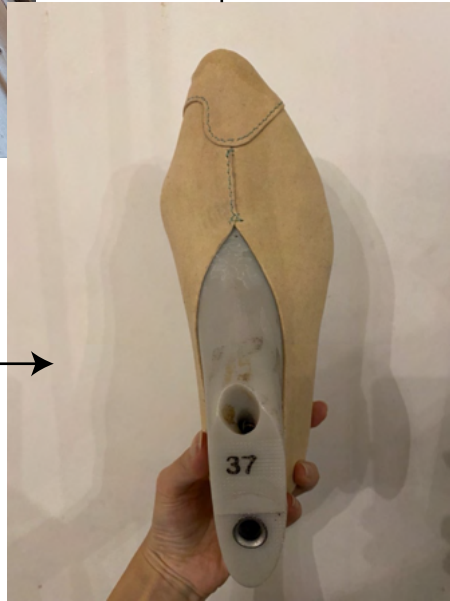

Toe Shape Test



Last Type Reference



Telescopic Last
The telescopic last will slide and reduce in length when slipping.

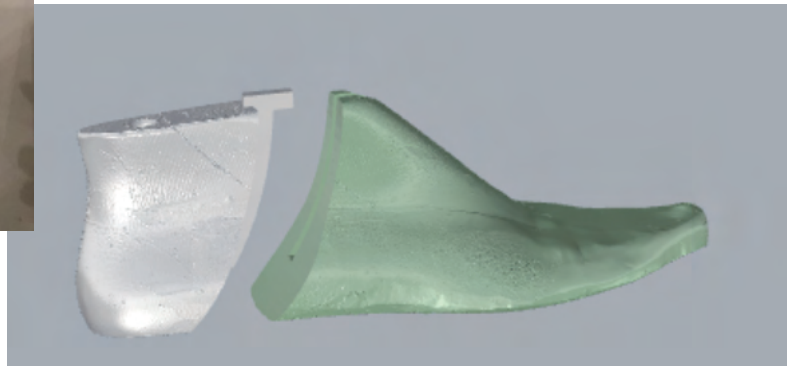

3D Work in Rhino



3D Print in PLA

3. 3D Outsole : Research



기 ㄴ ㄷ ㄱ ㅁ
 ㅂ ㅅ ㅇ ㅈ ㅊ
 ㅋ ㅌ ㅍ ㅎ ㅊ
 ㅊ ㅊ ㅊ ㅊ ㅊ
 ㅊ ㅊ ㅊ ㅊ ㅊ

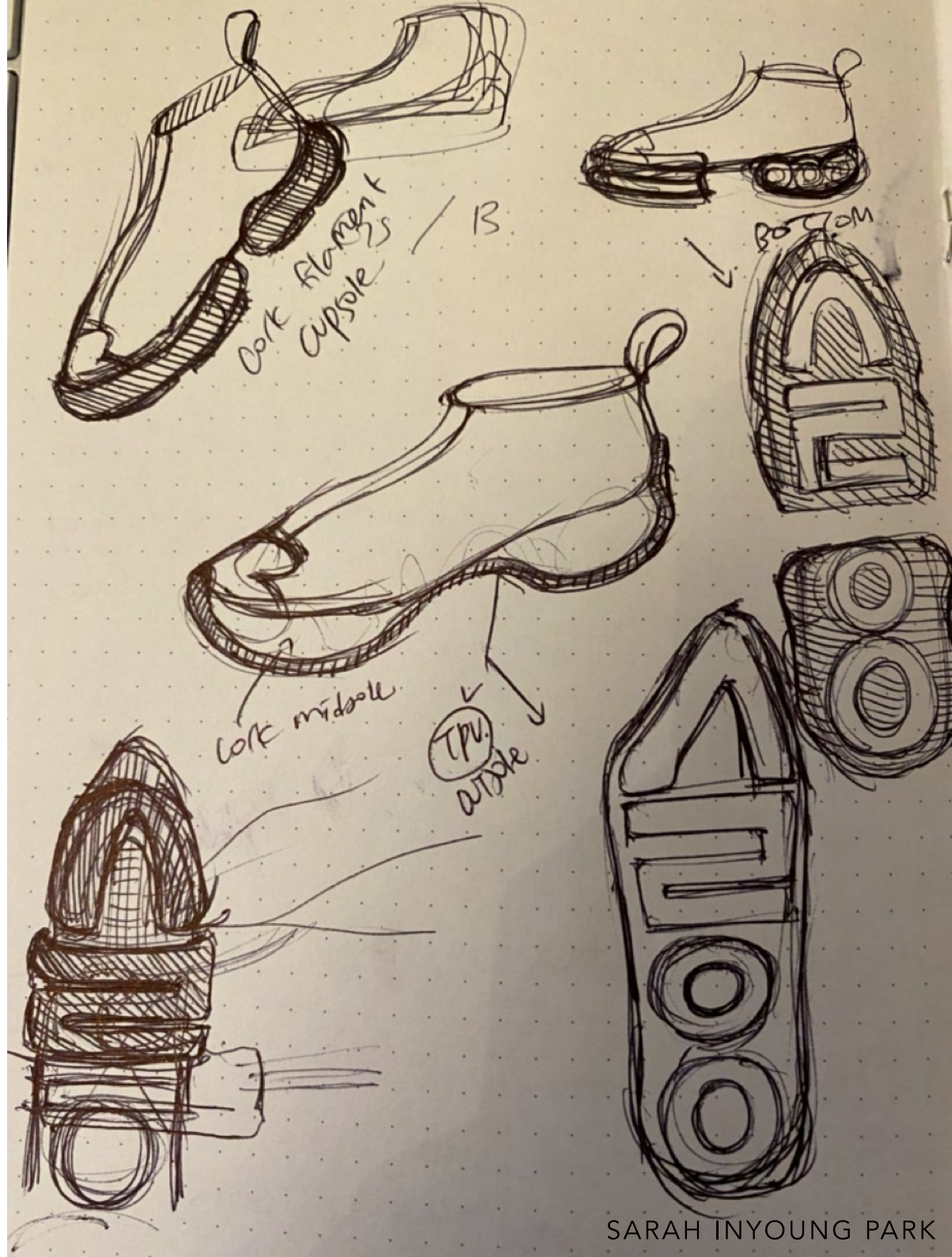

3. 3D Outsole : Design & Development



3. 3D Outsole : Design & Development

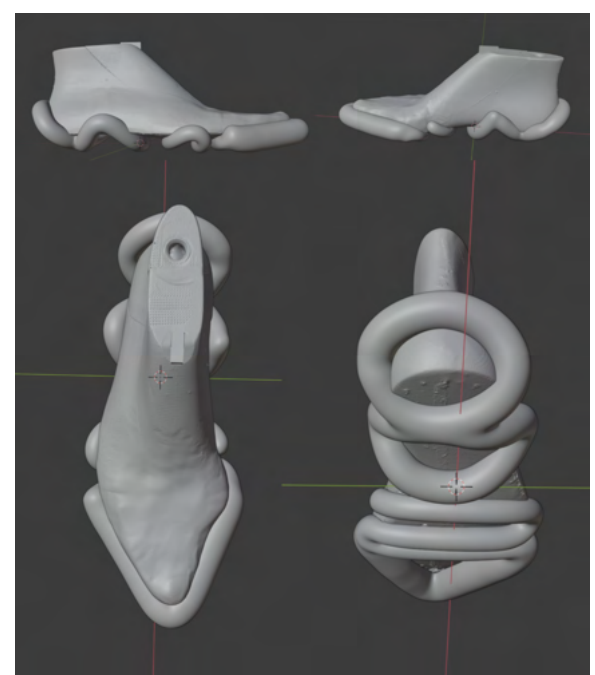

First TPU Print

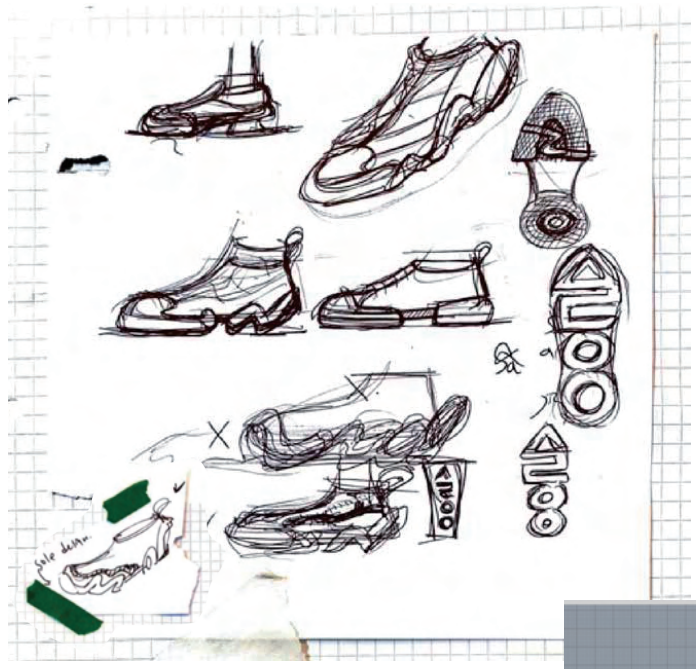

Second Prints

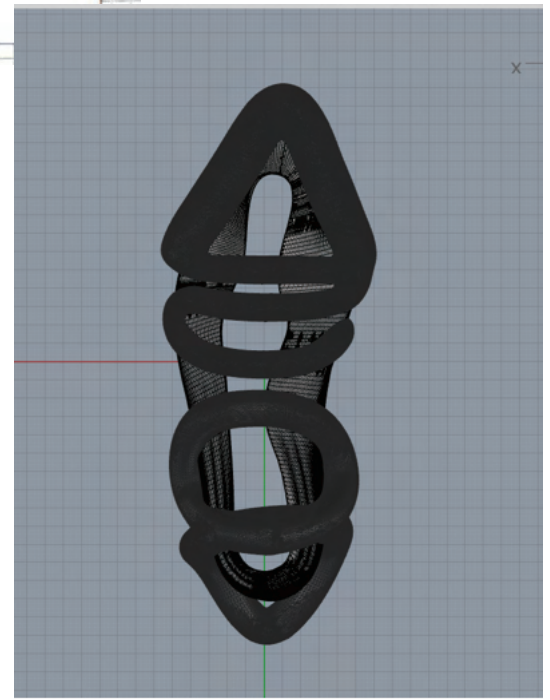

Final Design

3. 3D Outsole : Final Sample

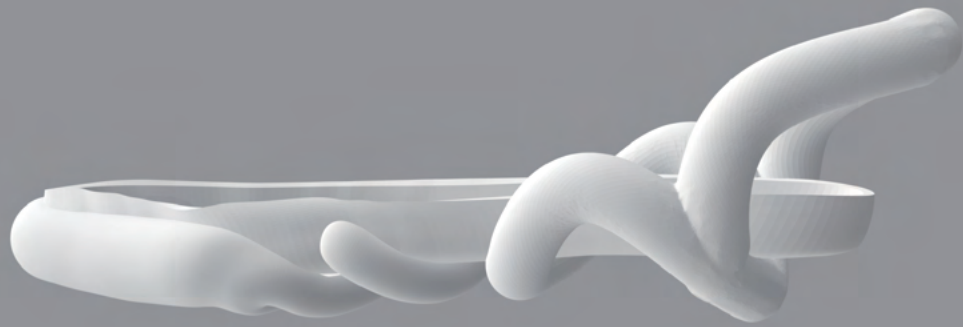

Outsole Design |

Style : Trainer

Col : TPU White/Black

Infill : 20% with two wall layers



3. 3D Outsole : Final Sample

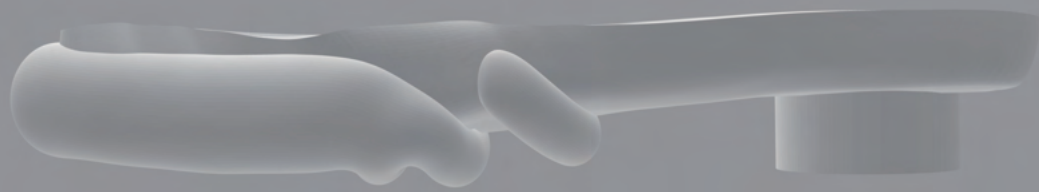

Outsole Design ||

Style : Pump

Col : TPU White/Black

Infill : 20% with two wall layers



3. 3D Outsole : Final Sample



Outsole Design III

Style : Platform
Col : TPU Black
Infill : 100% Solid



4. Upper : Concept

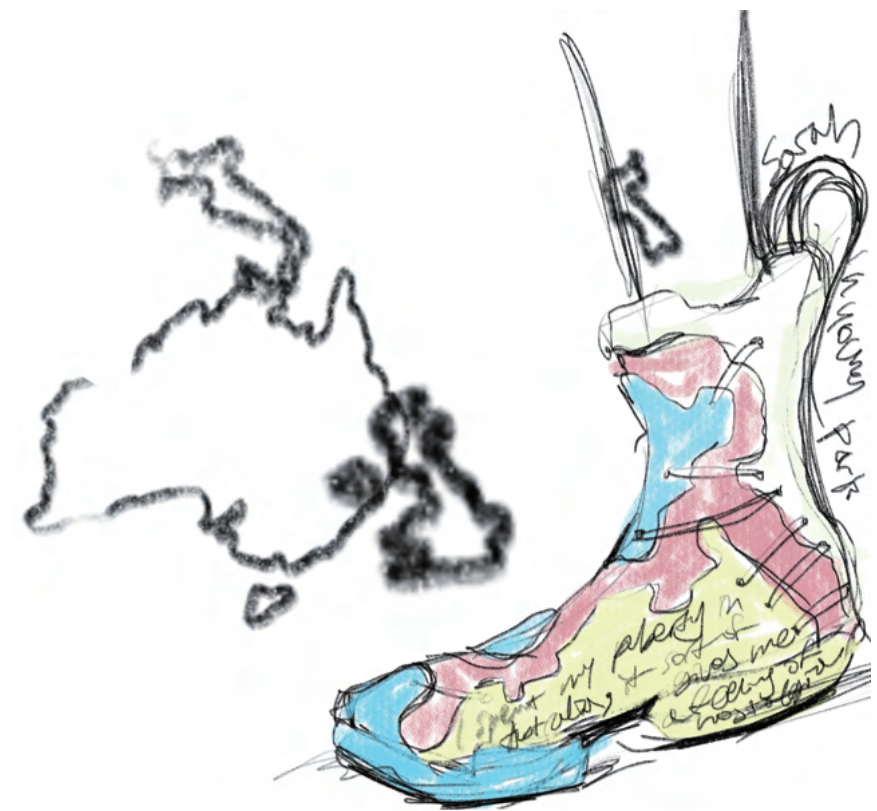

4. Upper : Initial process

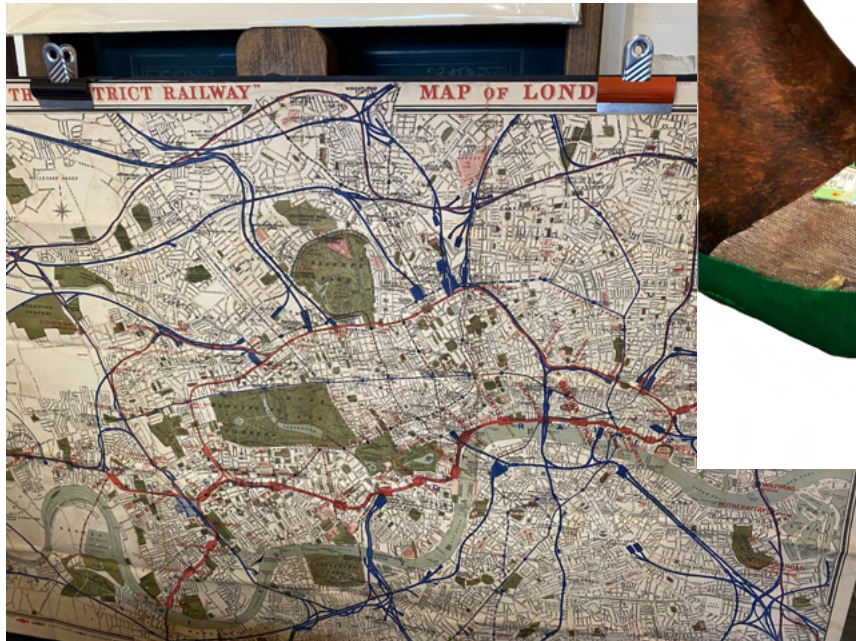

4. Upper : Digital Embroidery

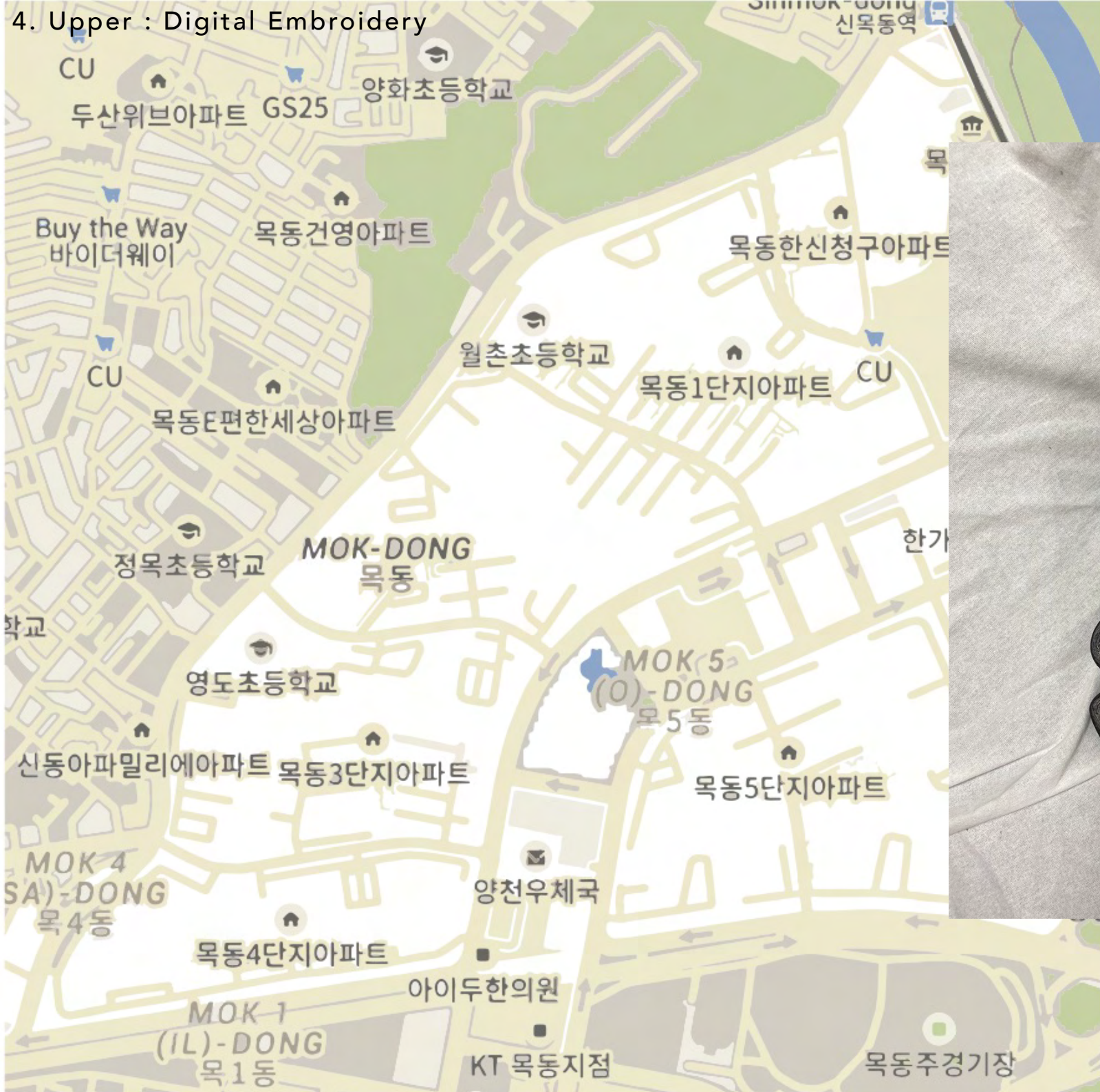

Mok-dong, Seoul
목동, 서울

SARAH INYOUNG PARK

4. Upper : UV Print

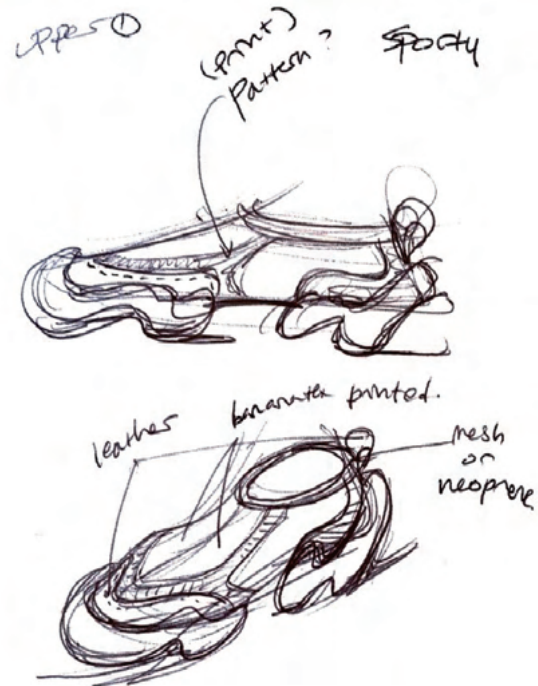

Mok-dong, Seoul
목동, 서울

4. Upper : Design Development

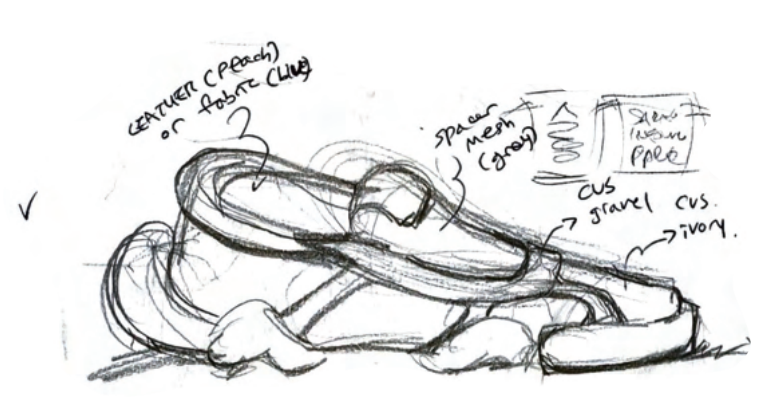

'Mok-dong' signature eye-stay Trainer

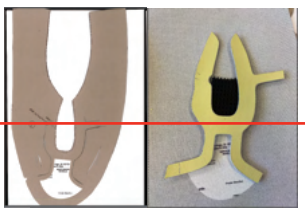

Via il Prato, Firenze
UV-Print



Earl's Court, London
Digital-Embroidery



Heel-Loop Pump

Mok-dong, Seoul
UV-Print



Causeway Bay, HK
Digital-Embroidery

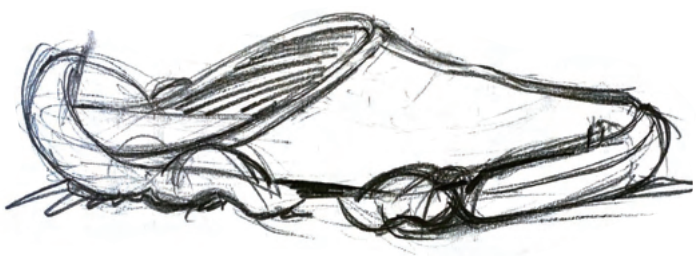

Mule

Cirqular Quay, Sydney
UV-print

